

13 Finney Drive, Chorlton Green, Manchester, M21 9DR



**JP&Brimelow**  
ESTATE AGENTS



# Offers In The Region Of £425,000

**\*\*VIDEO TOUR AVAILABLE\*\*** This spacious and extended THREE BEDROOM, link detached property with plenty of potential is situated on a quiet cul-de-sac location in the heart of Chorlton Green. Within a couple of minutes walk of the bustling Beech Road where you can enjoy the bars, restaurants and the boutique shops. The property is also close to the Chorlton Nature reserve, fantastic primary schools on your doorstep and all the amenities available in Chorlton with the direct access into the City centre, Manchester Airport and Media City via the Metrolink and bus routes. This property comprises of; a porch, spacious open plan lounge and dining area leading to an extended fitted kitchen with access out into the rear paved garden, a downstairs W.C and under stairs storage. Whilst to the first floor, there are three excellent sized bedrooms and a fitted three piece family bathroom and a separate W.C. The property benefits from gas fired central heating, brand new carpets throughout, refreshed décor, a rear South facing enclosed garden, off road parking to the front aspect and a large integral garage which can also be used for storage. Internal inspection highly recommended due to size available and superb location. OFFERED WITH NO VENDOR CHAIN.







## EPC Chart

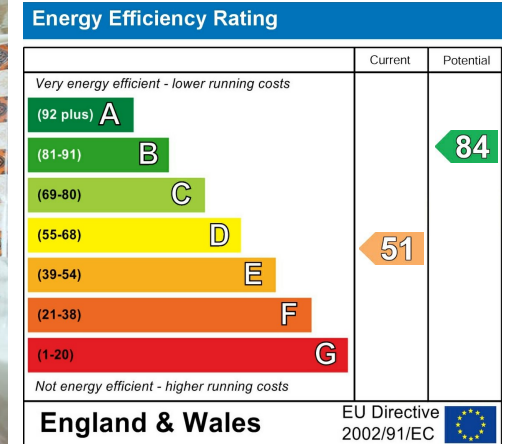

Tenure: **Freehold** Council Tax Band: **C**

## Ground Floor

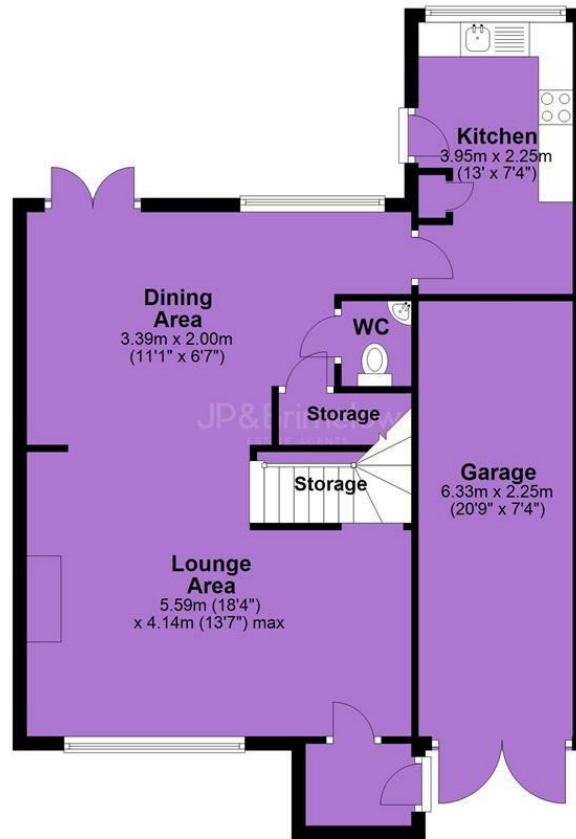

## First Floor

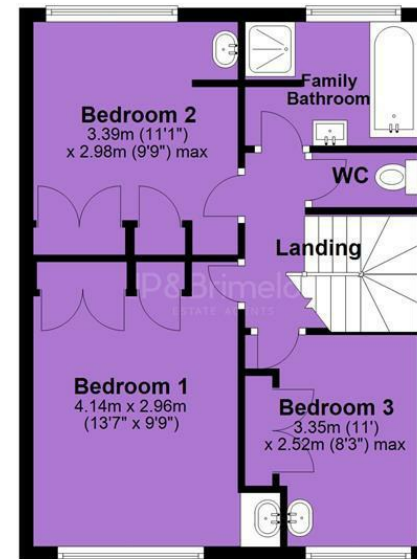

Chorlton & Didsbury Ltd  
430 Barlow Moor Road, Chorlton, Manchester, M21 8AD  
Chorlton: 0161 882 2233 Didsbury: 0161 448 0622  
E: [chorlton@jpbrimelow.co.uk](mailto:chorlton@jpbrimelow.co.uk) [www.jpbrimelow.co.uk](http://www.jpbrimelow.co.uk)



**JP&Brimelow**  
ESTATE AGENTS

NOTICE: J P & Brimelow Chorlton & Didsbury Ltd for themselves and for the vendors or lessors of this property whose agents they are give notice that:

- (i) the particulars are set out as a general outline only for the guidance of intending purchasers or lessees, and do not constitute, nor constitute part of, an offer or contract;
- (ii) all descriptions, dimensions, references to the condition and necessary permissions for use and occupation, and other details are given in good faith and are believed to be correct but any intending purchasers or tenants should not rely on them as statements or representations of fact but must satisfy themselves by inspection or otherwise as to the correctness of each of them;
- (iii) no person in the employment of JP & Brimelow Ltd has any authority to make or give any representation or warranty whatever in relation to this property.



Follow us on Twitter @jpandbrimelows